

SHIMANO

1988 REPAIR MANUAL

Shimano American Corporation, One Shimano Dr
Irvine, CA 9271

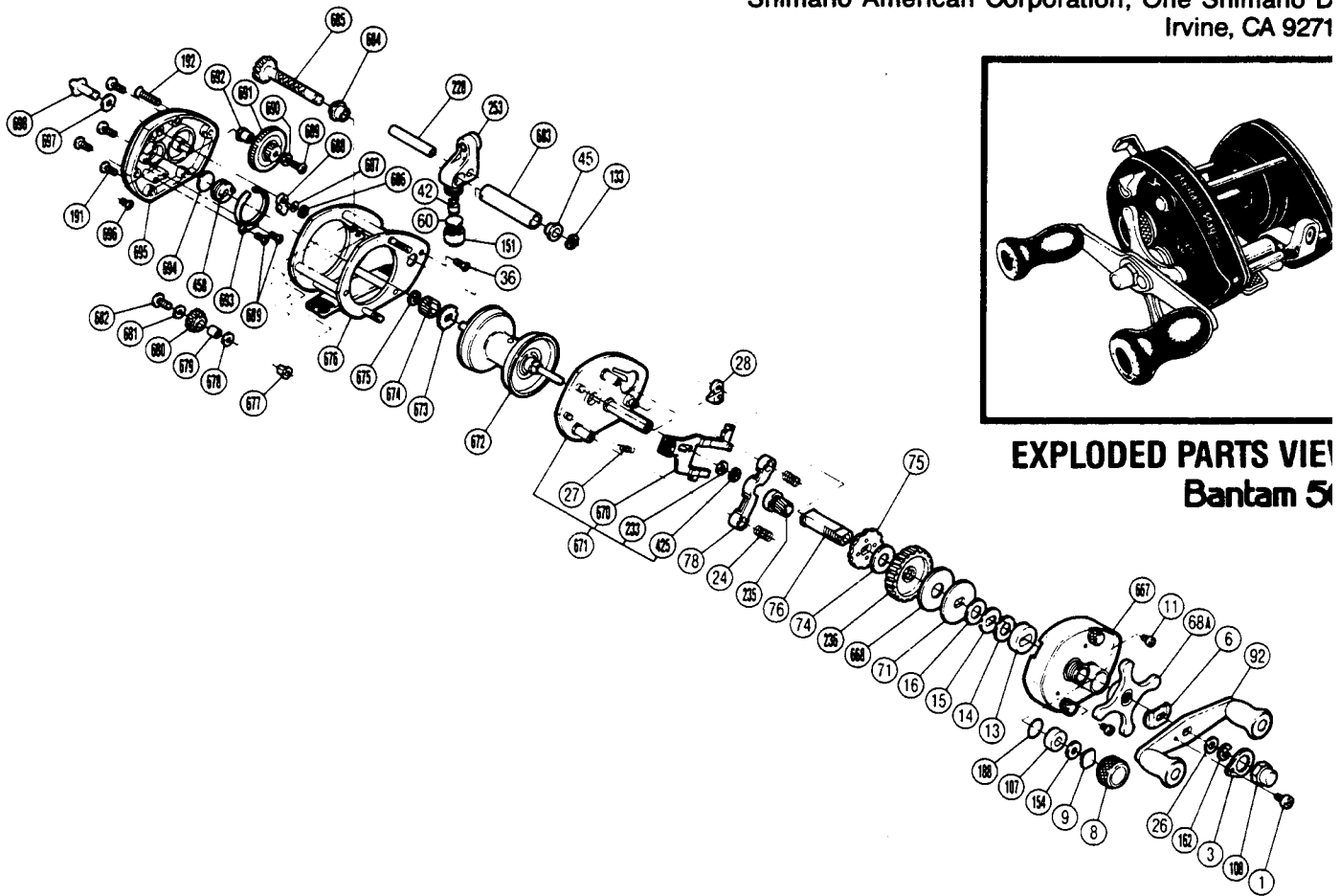

EXPLODED PARTS VIEW
Bantam 5

PARTS LIST

PART #	DESCRIPTION
BNT 0001	Handle Screw "B"
BNT 0003	Handle Nut (Lock) Plate
BNT 0006	Friction Washer (A)
BNT 0008	Cast Control Cap
BNT 0009	Spacer (A)
BNT 0011	Set Plate Screw
BNT 0013	Bushing (B)
BNT 0014	Friction Washer (B)
BNT 0015	Drag Spring Washer
BNT 0016	Friction Washer (C)
BNT 0024	(Pinion) Yoke Spring
BNT 0026	Drive Shaft Washer (A)
BNT 0027	Retractor Spring A
BNT 0028	Anti-Reverse Pawl Assembly
BNT 0036	Stabilizer Bar Screw (A) (S)
BNT 0042	Line Guide Pawl
BNT 0045	Worm Bearing (B)
BNT 0060	Spacer (Optional)
BNT 0068A	Drag Tri-Star (Cross)
BNT 0071	Pressure Plate
BNT 0074	Base Drag Washer
BNT 0075	Anti-Reverse Ratchet
BNT 0076	Drive Shaft
BNT 0078	Pinion Yoke
BNT 0092	Handle
BNT 0107	(New) Left Spool Bearing
BNT 0108	Handle Nut
BNT 0133	Worm Shaft Retainer
BNT 0151	Pawl Cap
BNT 0154	Felt Washer
BNT 0162	Drive Shaft Retainer
BNT 0188	O Ring
BNT 0191	Side Plate Screw
BNT 0192	Stabilizer Bar Screw (B)
BNT 0228	Stabilizer Bar
BNT 0233	Clutch Lever Spacer
BNT 0235	Pinion Gear
BNT 0236	Drive Gear
BNT 0253	Line Guide (Assembly)
BNT 0425	Clutchbutton Lock
BNT 0458	Bushing "A"
BNT 0667	Right Side Plate
BNT 0668	Drag Washer
BNT 0670	Clutch Button
BNT 0671	Set Plate Assembly
BNT 0672	Spool
BNT 0673	Click Gear
BNT 0674	Idle Gear "A"
BNT 0675	Idle Gear "A" Retainer
BNT 0676	Frame
BNT 0677	Idle Gear "D" Shaft
BNT 0678	Idle Gear "D" Spacer
BNT 0679	Idle Gear "D" Bushing
BNT 0680	Idle Gear "D"
BNT 0681	Idle Gear "D" Washer
BNT 0682	Idle Gear "D" Screw
BNT 0683	Level Wind Guard
BNT 0684	Worm Bearing (B)
BNT 0685	Worm Shaft
BNT 0686	Click Pawl Retainer
BNT 0687	Click Pawl Spacer
BNT 0688	Click Pawl
BNT 0689	Multi Purpose Screw
BNT 0690	Lock Washer
BNT 0691	Idle Gear "B"
BNT 0692	Idle Gear "B" Bushing
BNT 0693	Click Spring
BNT 0694	Spacer "B"
BNT 0695	Left Side Plate
BNT 0696	Bushing Retainer Screw
BNT 0697	Click Button Spacer
BNT 0698	Click Button